

IMPORTANT INFORMATION
 Dimensions to be confirmed on site prior to start of works and CDAS is to be informed of discrepancies immediately.
 All materials and works are to be carried out in accordance with current British Standards, Planning Approval, current Building Regulations and Codes of Practice.
 Party Wall Act -
 Notices under the Party Wall Act are to be served by the property owner or appointed third party by property owner.
 Health and Safety -
 CDM 2015 Regulations apply to all construction works to be carried out and apply to designers, contractors and the client. As such all parties have duties under these regulations.

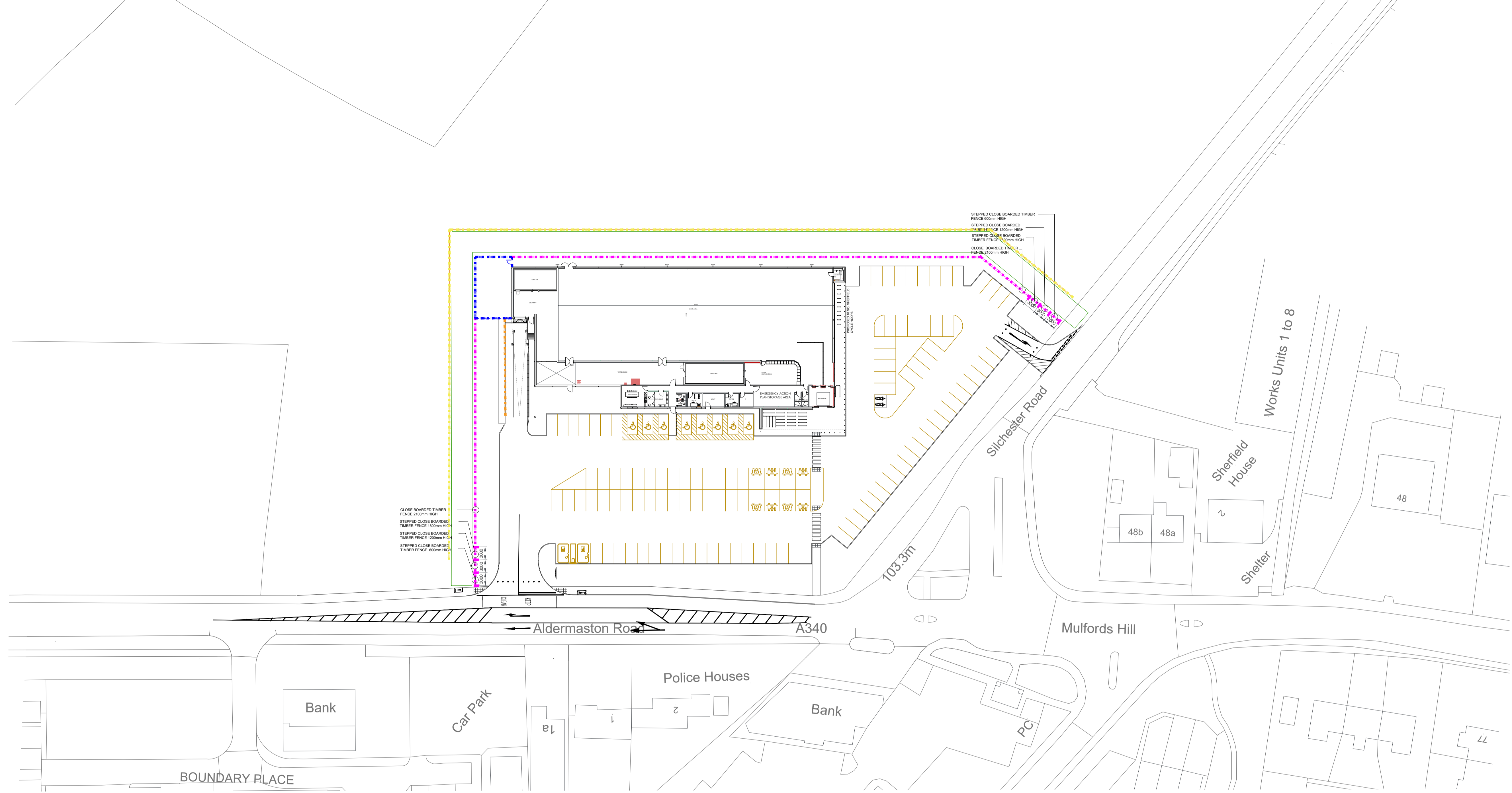

- BOUNDARY TREATMENTS KEY**
- CLOSE BOARDED TIMBER FENCING (STANDARD HEIGHT 2100mm)
 - ACOUSTIC FENCE: PROPOSED 2100mm ACOUSTIC (MIN 10Kg/m²) TIMBER FENCE INSTALLED.
 - VISI RAIL: 1100mm GALVANISED METAL VISI RAIL INSTALLED WITH VERTICAL RAILS SPACED NOT TO ALLOW A 100mm Ø SPHERE THROUGH IN ACCORDANCE WITH AD PART K
 - NEW 1100mm POST AND WIRE FENCE

Rev	Date	Description	Amendments
L	31.03.2020	Updated for emergency action plan	
K	10.01.2020	Landscaping buffer added	
J	30.09.2019	Highways updated in line with planners comments	
H	18.02.2019	Updated in line with client comments	path
G	28.02.2019	Updated in line with client comments	
F	24.02.2019	Updated in line with client comments	
E	20.02.2019	Car park layout updated	LMC
D	18.02.2019	Flood names updated	LMC
C	31.01.2019	278 works omitted	EB LMC
B	14.01.2019	Highways information updated	LMC
A	20.12.2018	Updated site as requested	EB DH

STATUS: PLANNING

Client
 LIDL GREAT BRITAIN LTD-
 FOXES PARK, BROWN HILL WAY
 SOUTHAMPTON, HAMPSHIRE, SO16 0AW
 Project
 MULFORDS HILL, TADLEY

Title
 PROPOSED BOUNDARY TREATMENT

Job No. 18004
 Drawing No. AD 115_REV L
 Drawn by EB
 Checked by LMC
 Date DEC 2018
 Scale 1:500 / 1:20
 Sheet A1

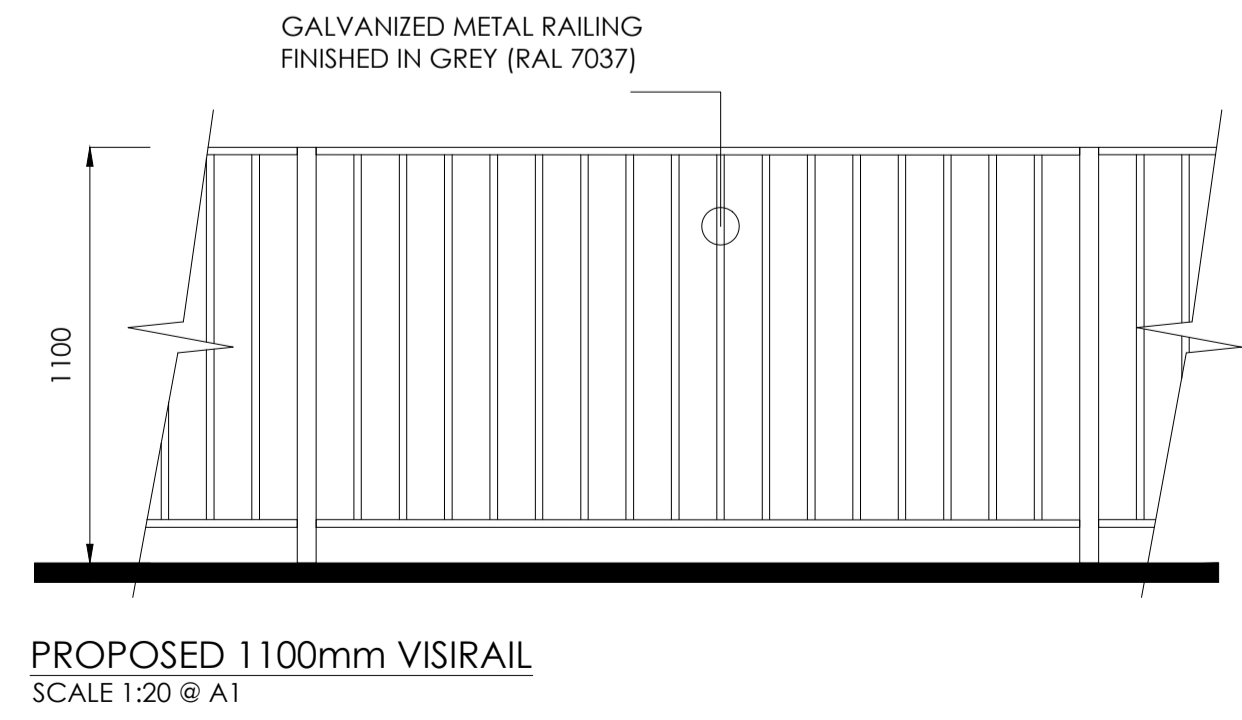
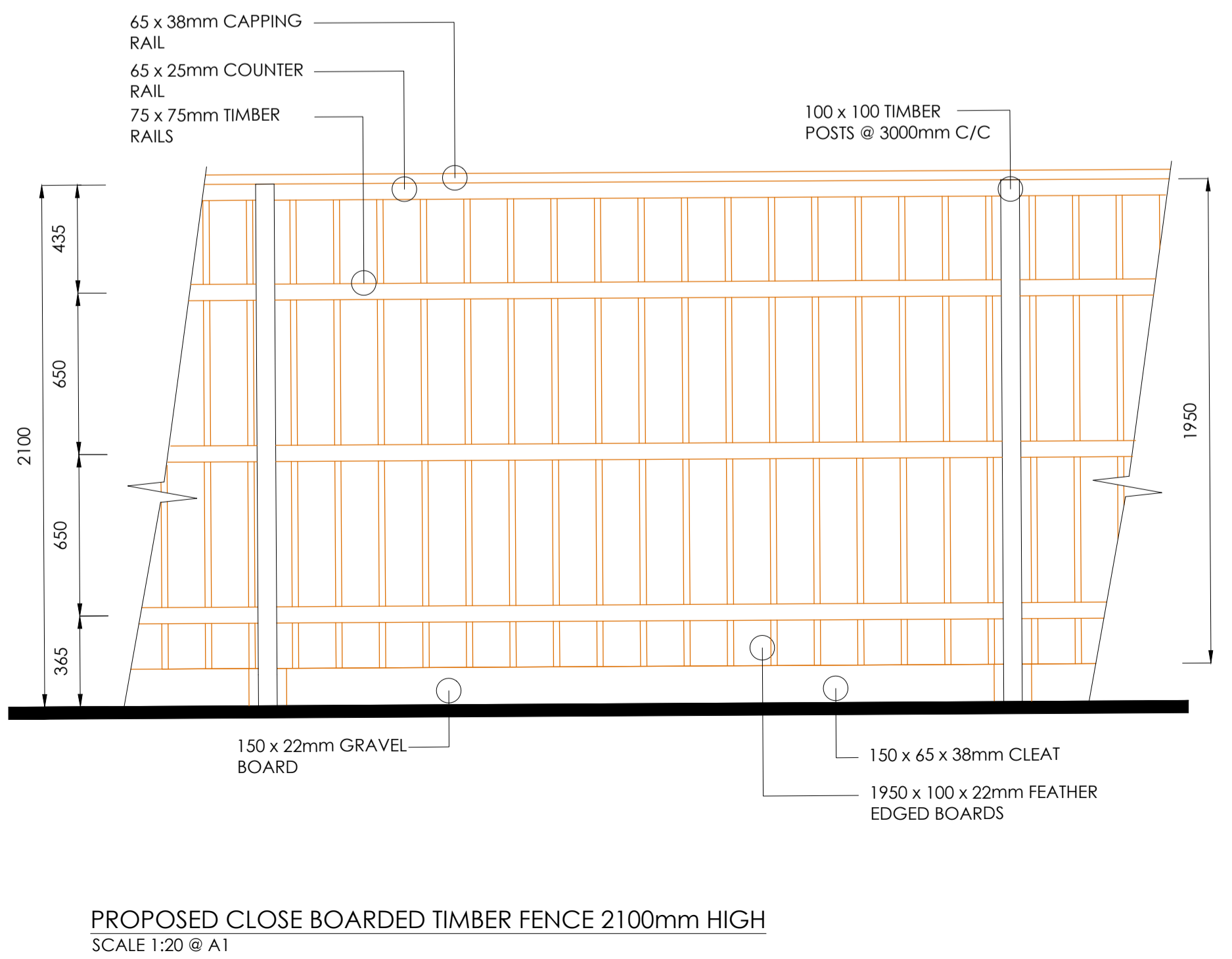
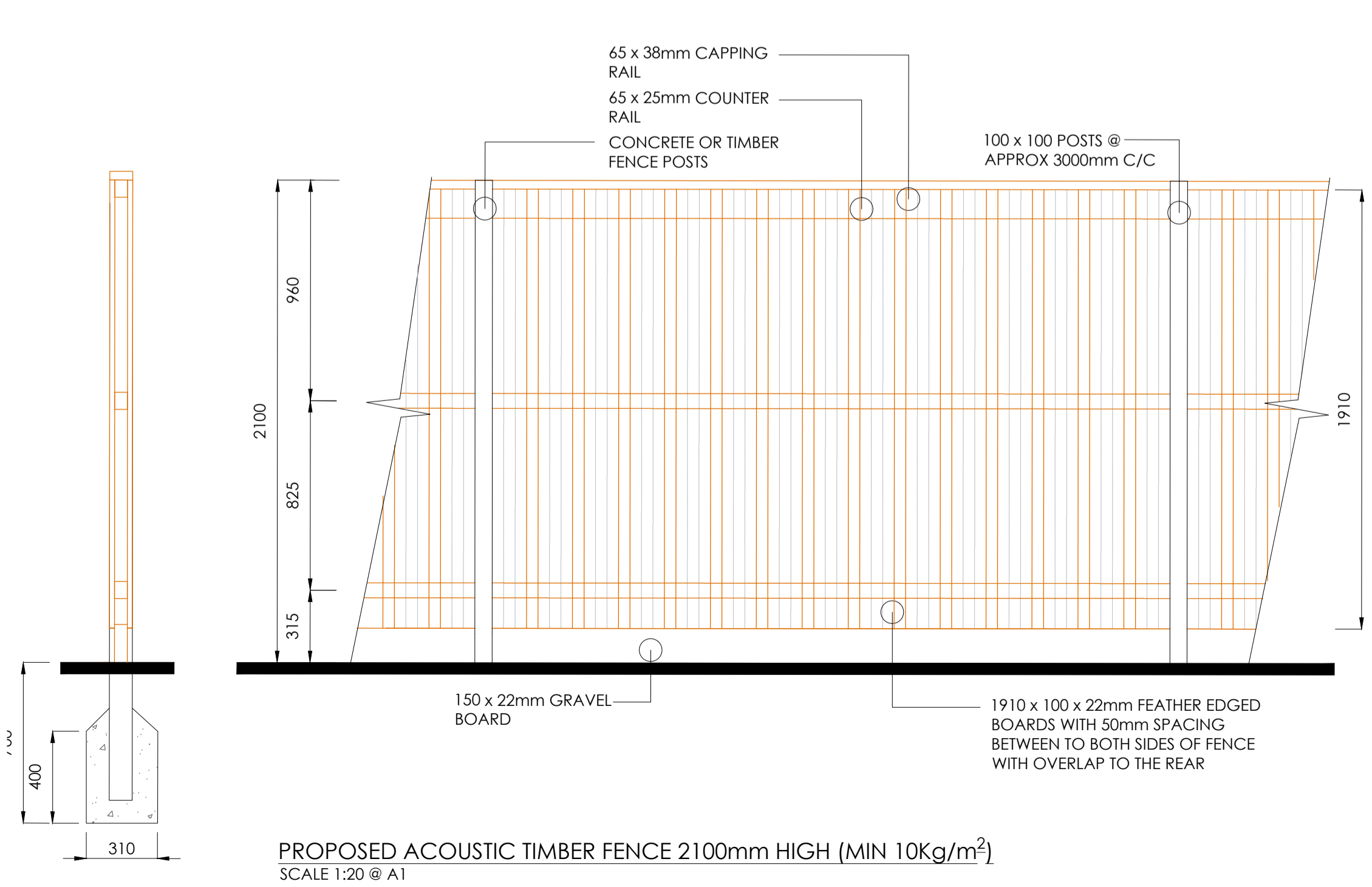

ARCHITECTURAL SERVICES

ONE DESIGN

Chartered Institute of Architectural Technologists
 Registered Practice

One Design Architectural Services Ltd
 Unit 1, Merchants Quay,
 Phase II, Ashley Lane, Shipley
 West Yorkshire, BD17 7DB
 0 1 2 7 4 5 9 1 1 8 8
 www.onedesignarchs.com
 mail@onedesignarchs.com

Registered in England and Wales Co No. 8355643